

## PRACTICAL INFORMATION

### CENTRE DE CONGRES DE LYON

50 Quai Charles de Gaulle  
69463 Lyon • France

#### Contact:

Richard BEDANE

[+33 \(0\)1 81 89 08 88](tel:+330181890888)

[bedane@proximumgroup.com](mailto:bedane@proximumgroup.com)

#### >> Programme

- 08.00 am TEXTIVAL opening
- 08.30 am Beginning of the business meetings
- 12.00 -02.00 pm Lunch
- 02.00 pm – 06.30 Business meetings

#### TEXTIVAL ENTRANCE

Access from the B entrance located at the bottom of the orange statue. The welcome desk will be at the -1 level.

#### EXHIBITOR ACCESS

**Welcoming:** Our team will welcome the exhibitors on July 1<sup>st</sup> 2019 from 02.00 pm to 06.00pm and on July 2<sup>nd</sup> 2019 from 07.30am.

**Material delivery:** Exhibitors must **ONLY** deliver their materials for the event on site on **July 1<sup>st</sup> 2019 in the afternoon.**

#### Mandatory mentions on the parcels:

Centre de congrès de Lyon

Textival ! – Forum 6

SOCIETE + NOM de l'exposant (+ téléphone)

1 quai Charles de Gaulle| 69006 LYON - FRANCE

**GPS coordinates: 45,47.132'N - 4,51.637'E**

**NO DELIVERY WILL BE TAKEN BY THE SITE BEFORE THIS DATE**

#### Access to the delivery area:

All the vehicles authorized to deliver parcels, will benefit from a time-limited parking of 30 minutes to load and unload.

Delivery vehicles with a height of less than 1.90m can be parked at the P0, P1 or P2 car parks.

Delivery vehicles with a height of less than 2.70m can be parked at the P2 car park.

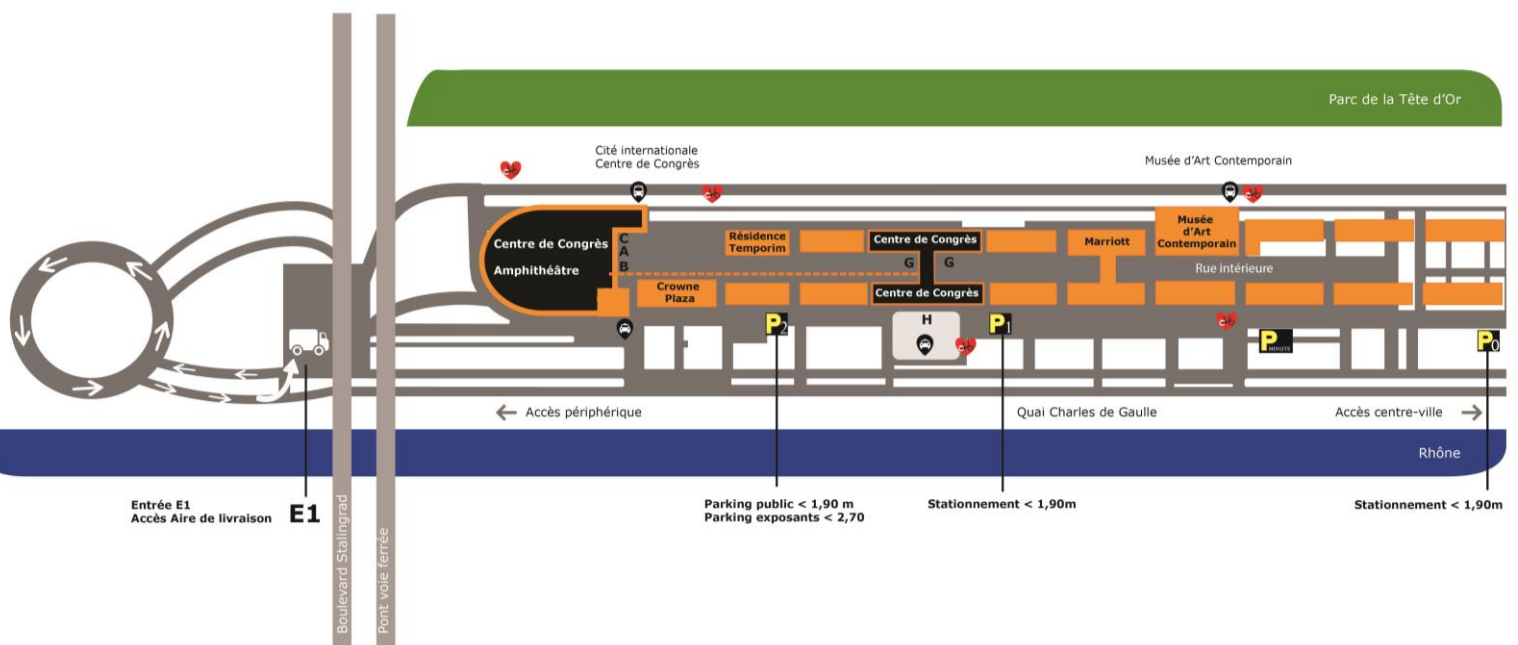

## PRACTICAL INFORMATION

### PUBLIC TRANSPORT

>> [Click here](#) for the access plan. [Click here](#) for the underground map.

>> Please download the timetables by clicking on the line number.

**C1** from Part Dieu train station take the line to Cuire and stop at Cité internationale - Centre de Congrès.

**C2** from Part Dieu train station take the line to Rillieux Semailles and stop at Cité internationale – Transbordeur.

**C4** from Jean Macé take the line to Cité internationale - Centre de Congrès and stop there.

**C5** from Cordeliers take the line to Rillieux Semailles or Vancia Château Bérard and stop at Cité internationale - Centre de Congrès.

**C26** from Grange Blanche take the line to Cité internationale - Transbordeur and stop at the terminus.

**Bus 70** from Part Dieu train station take the line to Neuville and stop at Cité internationale – Transbordeur.

### BY CAR

North ring road exit Porte de Saint Clair.

GPS Coordinates: Latitude: 45.7851676 | Longitude: 4.8528885.

1h30 from Geneva, 3h from Turin, 4h from Paris, 4h30 from Milan,

5h from Barcelona.

### PUBLIC PARKING

#### PARKING CITÉ INTERNATIONALE P1

34 Quai Charles De Gaulle, 69006, LYON

+33 (0)4 72 82 06 37

Maximum height: 2.70 m

Places: 1150

Benefit from à 30% discount booking your car park, clicking [here](#)

### TRAIN

20 min from Part Dieu train station

15 min from Perrache train station (between Lyon and Paris, a train every 30min at peaks times).

By train: 2 hours from Paris, 1h30 from Marseille and 4h from Brussels.

### AIR TRAVEL

Lyon Saint-Exupery airport: The Tram express connects the airport to Part Dieu train station. Time travel to the station: 29 minutes. <https://www.rhonexpress.fr/en>

### TAXI

Taxi Lyonnais: + 33 4 78 26 81 81

Taxi Lyon: + 33 4 72 10 86 86

Taxi Transport Rhône Alpes: +33 4 37 25 29 29

### HOTELS

<b>Lyon Marriott Hôtel**** Cité Internationale</b>	internationale, 70 Quai Charles de Gaulle, 69006 Lyon <i>To 3m from the site</i>	+33 04 78 17 50 50	h2951@accor.com
<b>Hôtel*** Crown plaza</b>	i Charles de Gaulle, 69006 Lyon <i>To 183m from the site</i>	+33 04 78 17 86 86	contact@cphotel-lyon.com
<b>Hôtel*** Ibis Lyon Palais des Congrès Caluire</b>	ZAC Saint Clair, 9 Avenue de Poumeyrol, 69300 Caluire <i>To 414m from the site</i>	+33 4 72 27 75 00	
<b>B&amp;B Hôtel*** Lyon Caluire Cité Internationale</b>	148-150 Grande Rue St Clair, 69300 Caluire-et-Cuire, France <i>To 669m from the site</i>	+33 8 92 68 70 76	
<b>IBIS Budget * 1.1km</b>	154 grande rue St Clair, 69300 CALUIRE ET CUIRE	+33 8 92 68 04 91	